

**REVISIONS**

NO.	DATE	DESCRIPTION

DATE  
 10.19.09  
 BCRA NO.  
 09081  
 CAD FILE  
 SHEET TITLE  
**MAIN FLOOR PLAN**

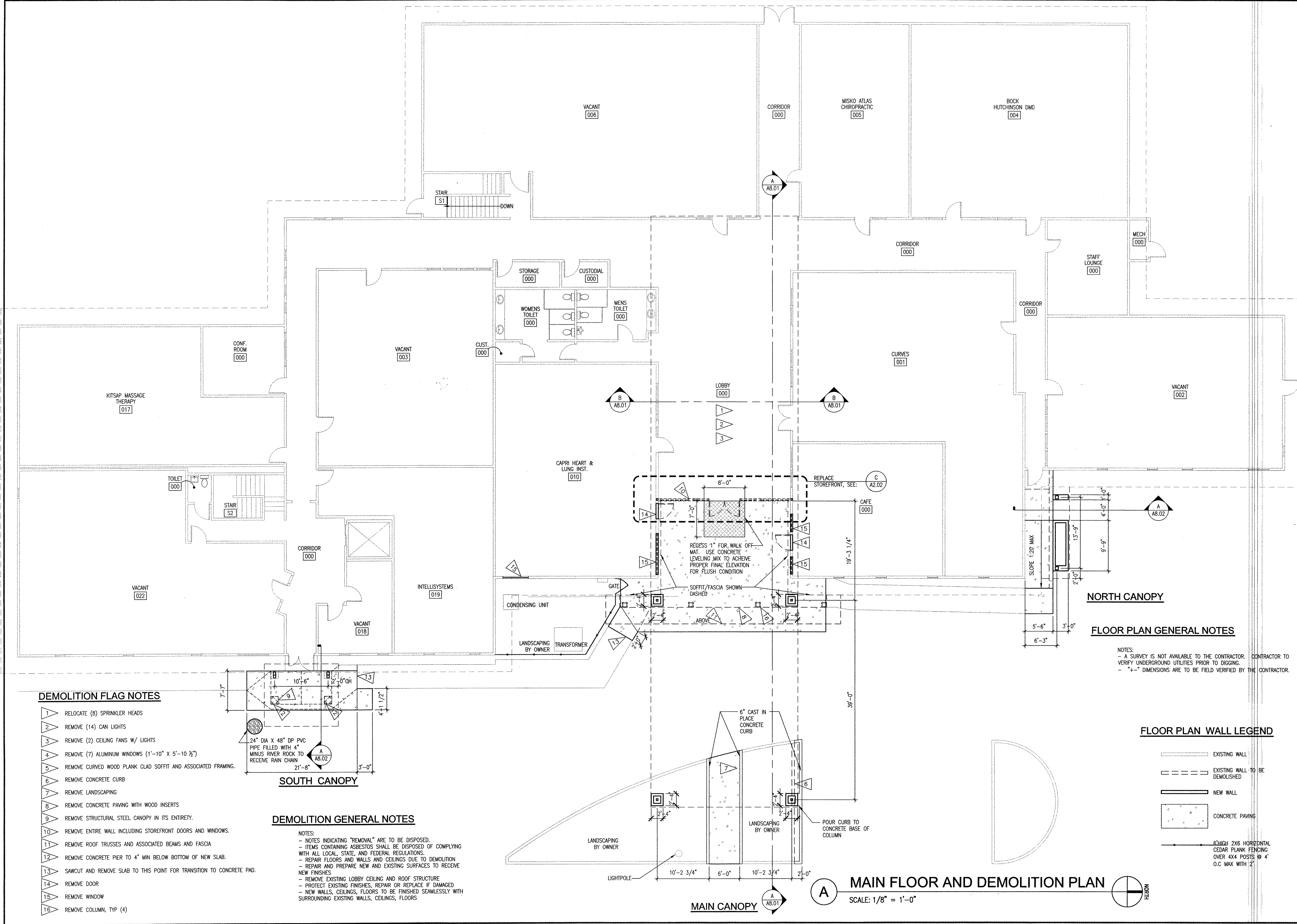

**DEMOLITION FLAG NOTES**

- 1 RELOCATE (8) SPRINKLER HEADS
- 2 REMOVE (14) CAN LIGHTS
- 3 REMOVE (2) CEILING FANS W/ LIGHTS
- 4 REMOVE (7) ALUMINUM WINDOWS (1'-10" X 5'-10 1/2")
- 5 REMOVE CURVED WOOD PLANK CLAD SOFFIT AND ASSOCIATED FRAMING.
- 6 REMOVE CONCRETE CURB
- 7 REMOVE LANDSCAPING
- 8 REMOVE CONCRETE PAVING WITH WOOD INSERTS
- 9 REMOVE STRUCTURAL STEEL CANOPY IN ITS ENTIRETY.
- 10 REMOVE ENTIRE WALL INCLUDING STOREFRONT DOORS AND WINDOWS.
- 11 REMOVE ROOF TRUSSES AND ASSOCIATED BEAMS AND FASCIA
- 12 REMOVE CONCRETE PIER TO 4" MIN BELOW BOTTOM OF NEW SLAB.
- 13 SAWCUT AND REMOVE SLAB TO THIS POINT FOR TRANSITION TO CONCRETE PAD.
- 14 REMOVE DOOR
- 15 REMOVE WINDOW
- 16 REMOVE COLUMN, TYP (4)

**DEMOLITION GENERAL NOTES**

NOTES:  
 - NOTES INDICATING "REMOVAL" ARE TO BE DISPOSED.  
 - ITEMS CONTAINING ASBESTOS SHALL BE DISPOSED OF COMPLYING WITH ALL LOCAL, STATE, AND FEDERAL REGULATIONS.  
 - REPAIR FLOORS AND WALLS AND CEILINGS DUE TO DEMOLITION  
 - REPAIR AND PREPARE NEW AND EXISTING SURFACES TO RECEIVE NEW FINISHES  
 - REMOVE EXISTING LOBBY CEILING AND ROOF STRUCTURE  
 - PROTECT EXISTING FINISHES, REPAIR OR REPLACE IF DAMAGED  
 - NEW WALLS, CEILINGS, FLOORS TO BE FINISHED SEAMLESSLY WITH SURROUNDING EXISTING WALLS, CEILINGS, FLOORS

**FLOOR PLAN GENERAL NOTES**

NOTES:  
 - A SURVEY IS NOT AVAILABLE TO THE CONTRACTOR. CONTRACTOR TO VERIFY UNDERGROUND UTILITIES PRIOR TO DIGGING.  
 - "+-" DIMENSIONS ARE TO BE FIELD VERIFIED BY THE CONTRACTOR.

**FLOOR PLAN WALL LEGEND**

- EXISTING WALL
- EXISTING WALL TO BE DEMOLISHED
- NEW WALL
- CONCRETE PAVING
- FINISH 2X6 HORIZONTAL CEDAR PLANK FENCING OVER 4X4 POSTS @ 4' O.C. MAX WITH 2"

**MAIN FLOOR AND DEMOLITION PLAN**

SCALE: 1/8" = 1'-0"

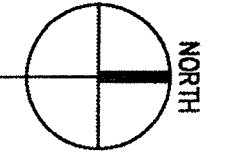

Date Plotted: Oct. 20, 2009 - 10:50am Filename: 09081-A201.dwg By: NATHANIEL